

DS-2CD7153-E / DS-2CD7164-E

Network Mini Dome Camera

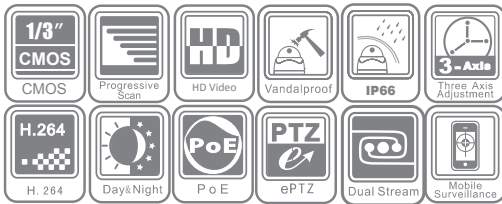

Key features

- 1/3" progressive scan CMOS
- H.264 / MPEG4 / MJPEG video compression
- Up to 2 megapixel resolution
- HD 720P real time video
- Day / night auto switch
- Vandal-proof housing
- IP66 rating

Dimensions

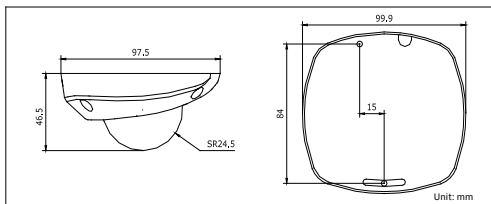

	DS-2CD7153-E (2MP)	DS-2CD7164-E (1.3MP)
Camera		
Image sensor	1/3" progressive scan CMOS	
Min. illumination	0.5 lux@F1.2, AGC on 0.1 lux@F1.2, AGC on, sens-up × 5 1.1 lux@F1.8, AGC on 0.2 lux@F1.8, AGC on, sens-up × 5	0.01 lux @F1.2, AGC ON 0.02 lux @F1.8, AGC ON
Shutter time	1/25s ~ 1/100,000s	
Lens	4mm @F1.8 (2.8, 6, 8mm optional), angle of view: 68°	4mm @F1.8 (2.8, 6, 8mm optional), angle of view: 68°
Lens mount	M12	
Angle adjustment	Pan: ± 15°, tilt: 0 ~ 90°, rotation: ± 15°	
Day & night	Electronic	
Compression standard		
Video compression	H.264 / MPEG4 / MJPEG	
Bit rate	32 Kbps ~ 16 Mbps	
Dual stream	Yes	
Image		
Max. image resolution	1600 x 1200	1280 × 960
Frame rate	50 Hz: 12.5 fps (1600 × 1200) 12.5 fps (1600 × 912) 25 fps (1280 × 960) 25 fps (1280 × 720) 60 Hz: 15 fps (1600 × 1200) 15 fps (1600 × 912) 25 fps (1280 × 960) 30 fps (1280 × 720)	50Hz: 25fps (1280 × 960), 25fps (1280 × 720) 60Hz: 30fps (1280 × 960), 30fps (1280 × 720)
Image settings	Saturation, brightness, contrast adjustable through client software or web browser	
Network		
Network storage	NAS (iSCSI optional)	
Alarm trigger	Motion detection, tampering alarm, network disconnect, IP address conflict	
Protocols	TCP/IP, HTTP, DHCP, DNS, DDNS, RTP, RTSP, PPPoE, SMTP, NTP, SNMP, HTTPS, FTP, 802.1x, Qos (SIP, SRTP, IPv6 optional)	
Security	User authentication, watermark	
System compatibility	ONVIF, PSIA, CGI	
Interface		
Communication interface	1 RJ45 10M / 100M ethernet port	
Reset button	Yes	
General		
Operating conditions	-25°C ~ 60°C (-13°F ~ 140°F) humidity 95% or less (non-condensing)	
Power supply	12 VDC ± 10%, PoE (802.3af)	
Power consumption	max. 4W	
Impact protection	IEC60068-275Eh, 50J; EN50102, up to IK10	
Weather-proof rating	IP66	
Dimensions	99.9 × 97.5 × 46.5 mm (3.93" × 3.84" × 1.83")	
Weight	250g (0.55 lbs)	

Available models

DS-2CD7153-E (2MP), DS-2CD7164-E (1.3MP)

* Product picture and technical specs subject to change without previous notice. For product availability, please contact our local sales representatives.